

# DXE 00

## 🇬🇧 Sleeve anchor with nut, zinc plated, ETA-CE Opt.7 certified

- 🇫🇷 Cheville à douille zinguée avec cône fixe, certification ETE-CE Option 7
- 🇩🇪 Verzinkter Hülsenanker mit festem Konus, mit ETA-CE Zulassung Option 7
- 🇪🇸 Anclaje de camisa con cono enganchado, de acero cincado, Homologado ETA-CE Opción 7
- 🇷🇺 Втулочный стальной оцинкованный анкер, с сертификатом ETA-CE опция 7



European Technical Approval  
**OPTION 7** for non-cracked concrete  
**ETAG 001 - PART 1 and 2**  
 DoP available on [www.tecfi.it/DoP](http://www.tecfi.it/DoP)



Item code	Anchor size Ø x La (mm)	Pcs. per box	Pcs. per carton
Ø 10			
DXE 00 10 045	10 x 45	100	1.000
Ø 12			
DXE 00 12 050	12 x 50	50	500
Ø 15			
DXE 00 15 060	15 x 60	25	250
Ø 18			
DXE 00 18 075	18 x 75	20	200
ETA-CE Option 7 Certified item / Agrément technique européen ETE-CE / ETA-CE Zulassung Homologación ETA-CE / Сертификация ETA-CE			

### Sleeve anchor only (sleeve + cone nut).

The ETA-CE for this item will be issued for the sleeve anchor only, but the screw and the washer MUST respect the following requirements:  
 - Hexagonal head screw according to DIN 933 (ISO 4017), 8.8 grade according to ISO 898-1, zinc plating min. 5 µm. according to ISO 4042.  
 - Washer according to ISO 7089, hardness class HV200; zinc plating min. 5 µm. according to ISO 4042.

# DXE 01

## 🇬🇧 Sleeve anchor with nut, with hex head screw 8.8 grade and washer, zinc plated, ETA-CE Opt.7 certified

- 🇫🇷 Cheville à douille avec cône fixe, avec vis tête hexagonale classe 8.8, certification ETE-CE Option 7
- 🇩🇪 Verzinkter Hülsenanker mit festem Konus und Sechskantschraube Klasse 8.8, mit ETA-CE Zulassung Option 7
- 🇪🇸 Anclaje de camisa con cono enganchado, montado con tornillo cabeza hexagonal clase 8.8, de acero cincado, Homologado ETA-CE Opción 7
- 🇷🇺 Втулочный стальной оцинкованный анкер с болтом с шестигранной головкой класса 8.8, с сертификатом ETA-CE опция 7



European Technical Approval  
**OPTION 7** for non-cracked concrete  
**ETAG 001 - PART 1 and 2**  
 DoP available on [www.tecfi.it/DoP](http://www.tecfi.it/DoP)



Item code	Anchor size Ø x La / t <sub>fix</sub> (mm)	Screw size M x Ls (mm)	Pcs. per box	Pcs. per carton
Ø 10 - M6 - Ch 10				
DXE 01 10 050	10 x 45 / 5	M6 x 50	50	500
Ø 12 - M8 - Ch 13				
DXE 01 12 060	12 x 50 / 10	M8 x 60	50	500
Ø 15 - M10 - Ch 17				
DXE 01 15 080	15 x 60 / 20	M10 x 80	25	250
Ø 18 - M12 - Ch 19				
DXE 01 18 100	18 x 75 / 20	M12 x 100	20	100
ETA-CE Option 7 Certified item / Agrément technique européen ETE-CE / ETA-CE Zulassung / Homologación ETA-CE / Сертификация ETA-CE				

Usage / Utilisation / Benutzung / Uso / Применение



Zinc plated sleeve anchor with "hooked" nut, ETA-CE Opt.7 certified, for pre-positioned heavy duty fixings in non-cracked concrete. Item included in **TADS - Tecfi Anchor Design Software** for computer aided design of Anchorage.

DoP



Declaration of Performance

Box / Boîte / Verpackung / Caja / Упаковка



Also available in the PE blister bag



Installation sequence / Instructions de mise en oeuvre / Setzanweisung / Secuencia de instalación / Порядок монтажа

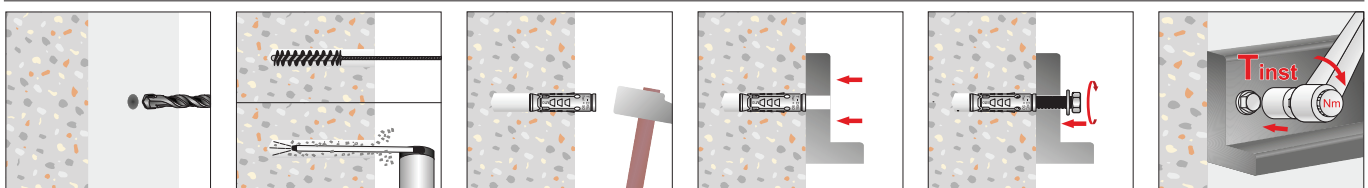

### Related products

124

HXE-CONCRETO® HWH concrete screw



HXE01  
p. 102

A4 (AISI 316) S/S sleeve anchor with nut



DX70  
p. 127

DIN933 - UNI5739 - Hex head screw



RL  
p. 399

SDS-PLUS masonry drill



EO  
p. 427

Pump for hole cleaning



DW  
p. 168