

ZJE 71

UK A4 (AISI 316) stainless steel wedge anchor, with nut and washer, ETA-CE Opt.7 certified

- FR Barre d'ancrage en acier Inox A4 (AISI 316) avec écrou et rondelle, certification ETE-CE Option 7
- DE Bolzenanker aus Edelstahl A4 (AISI 316) mit Sechskantmutter und Scheibe, mit ETA-CE Zulassung Option 7
- ES Anclaje macho montado con tuerca y arandela, de Acero Inoxidable A4 (AISI 316), Homologado ETA-CE Opción 7
- RU Анкерный болт со специальным распорным кольцом из нержавеющей стали A4 (AISI 316), с гайкой и шайбой, с сертификатом ETA-CE опция 7

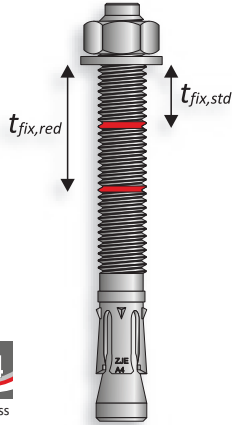

European Technical Assessment
ETAG 001 - PART 1 and 2
OPTION 7 for non-cracked concrete
DoP available on www.tecfi.it/DoP

Item code	Anchor size Ø x La (mm)	Maximum thickness of fixture*		Pcs. per box	Pcs. per carton
		t _{fix,std}	t _{fix,red}		
Ø 6 - AF 10					
★ ZJE 71 06 060	6 x 60	2	-	100	1.000
★ ZJE 71 06 080	6 x 80	22	-	100	1.000
Ø 8 - AF 13					
★ ZJE 71 08 075	8 x 75	5	18	100	500
★ ZJE 71 08 090	8 x 90	20	33	100	500
★ ZJE 71 08 115	8 x 115	45	58	50	500
Ø 10 - AF 17					
★ ZJE 71 10 070	10 x 70	-	3	50	250
★ ZJE 71 10 090	10 x 90	10	23	50	250
★ ZJE 71 10 120	10 x 120	40	53	50	250
★ ZJE 71 10 150	10 x 150	70	83	50	250
Ø 12 - AF 19					
★ ZJE 71 12 090	12 x 90	-	13	50	250
★ ZJE 71 12 110	12 x 110	18	33	25	125
★ ZJE 71 12 140	12 x 140	48	63	25	125
Ø 16 - AF 24					
★ ZJE 71 16 090	16 x 90	-	4	25	125
★ ZJE 71 16 125	16 x 125	3	-	25	125
★ ZJE 71 16 145	16 x 145	23	-	20	100
★ ZJE 71 16 170	16 x 170	48	-	15	75
Ø 20 - AF 30					
★ ZJE 71 20 170	20 x 170	23	-	10	50
★ ZJE 71 20 220	20 x 220	73	-	5	25
★ ETA-CE Option 7 Certified item / Agrément technique européen ETE-CE / ETA-CE Zulassung / Homologación ETA-CE / Сертификация ETA-CE ⚠ Item without ETA-CE Certification / Article sans certification / Artikel ohne Zulassung / Medida no homologada ETA-CE / Арматурный без сертификата ETA-CE					

New Item
New Item

Usage / Utilisation / Benutzung / Uso / Применение



For heavy duty fixings in non-cracked concrete.
Item included in TADS - Tecfi Anchor Design Software for computer aided design of Anchorage.

Box / Boîte / Verpackung / Caja / Упаковка

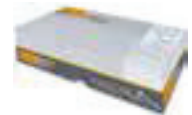

Installation sequence / Instructions de mise en oeuvre / Setzanweisung / Secuencia de instalación / Порядок монтажа

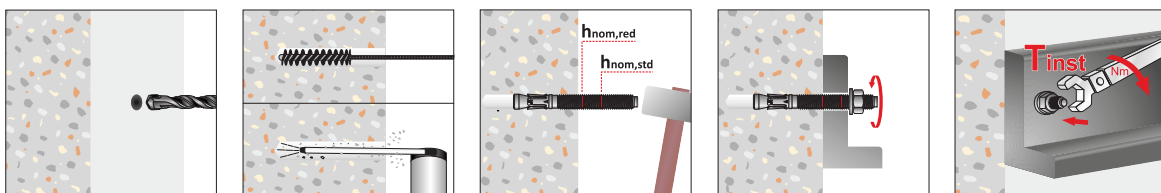

t_{fix,std} - maximum thickness of fixture with standard embedment depth (see ETA 13/1012)
t_{fix,red} - maximum thickness of fixture with reduced embedment depth (see ETA 13/1012)

DoP



Declaration of Performance

Related products

140

